

# 2052 Quick Installation Guide

5/08

## UNPACKING

1. Inspect package for damage.
2. Remove 2052 from box and place on a solid level surface. **Caution:** Two people are required to lift machine out of box, as it weighs 90 lbs.
3. Inspect packing to ensure all components are included.

## Components



2052 pressure sealer

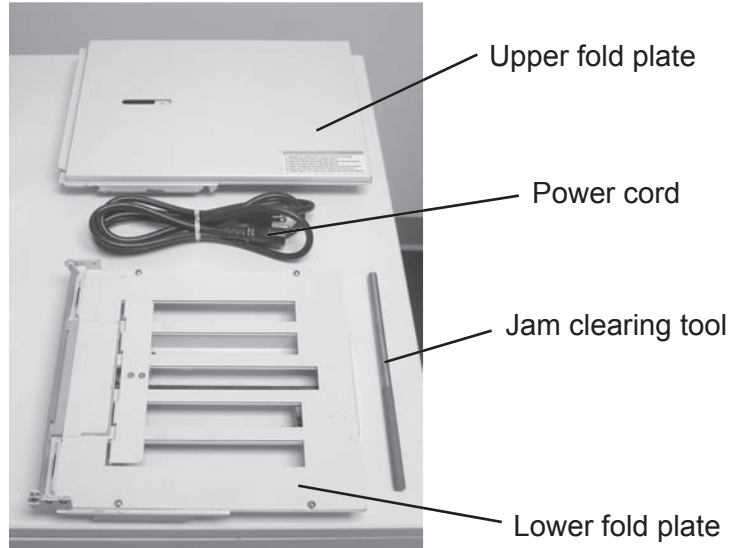

## INSTALLATION

### 1. Infeed Tray Extension



Lift infeed tray extension and lock into place.



### 2. Lower Fold Plate

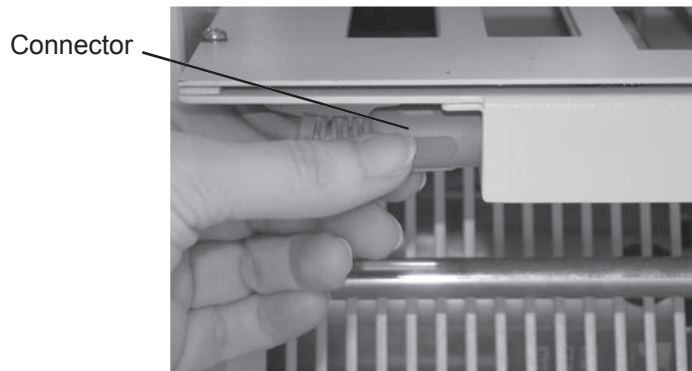
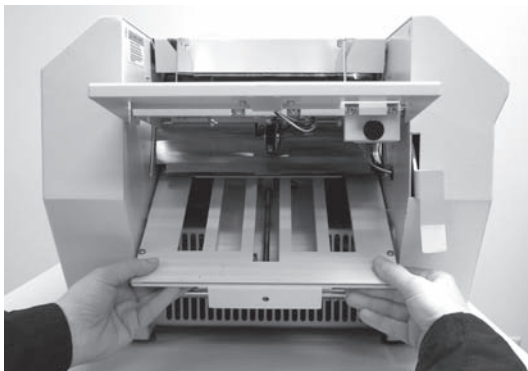

Insert lower fold plate under the infeed tray. Plug in connector to fold plate.

### 3. Upper Fold Plate



Lift top cover for access to install upper fold plate

#### Top View

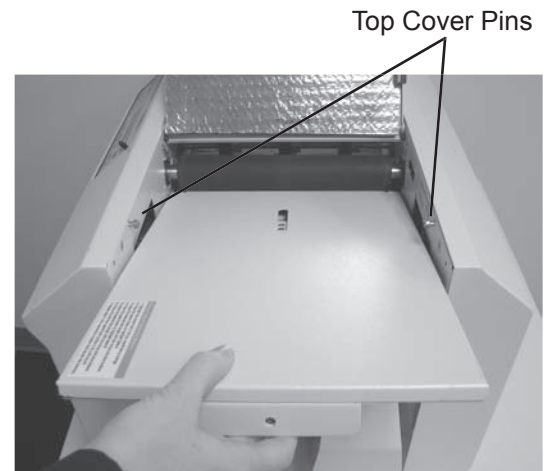
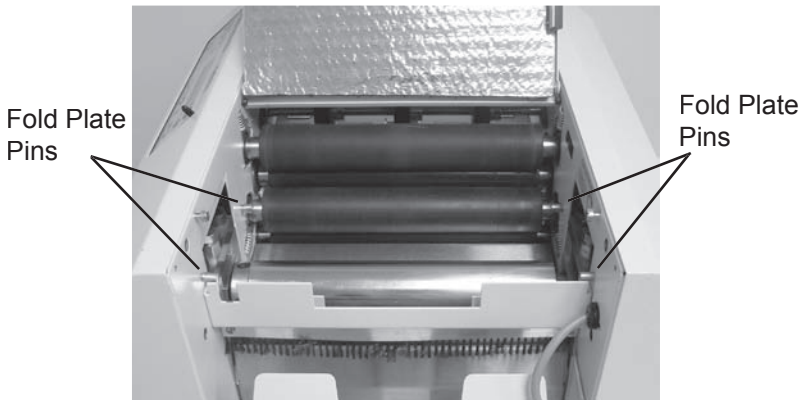

a. Slide the upper fold plate under the top cover pins onto the fold plate pins.

**Note:** The fold plate pins are a yellowish color and the top cover pins are a chrome color. Slide the fold plate under the top cover pins when setting into position.

b. Plug in connector to upper fold plate.

c. Close top cover.

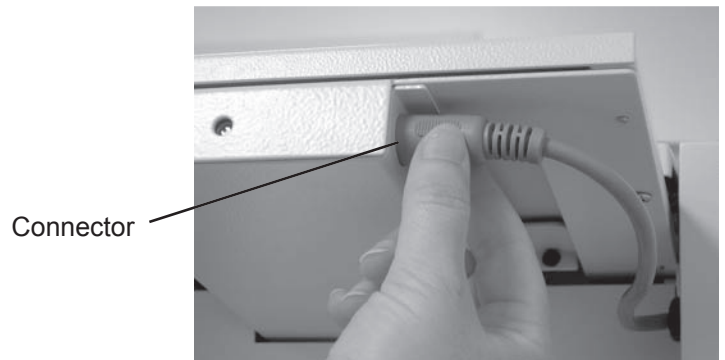

## Side View

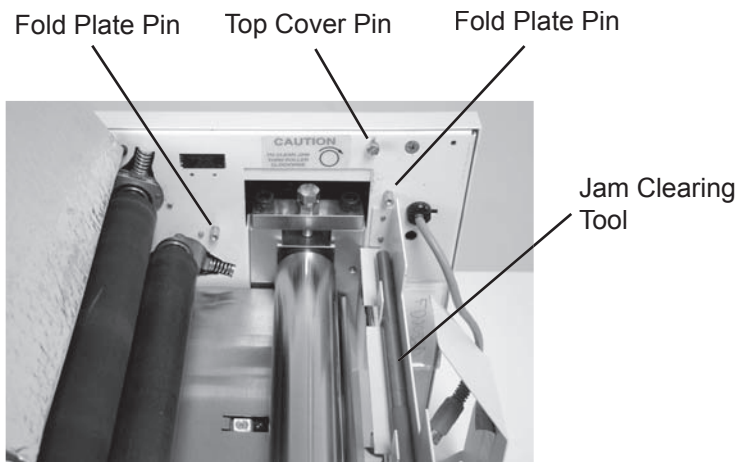

## 4. Power Cord

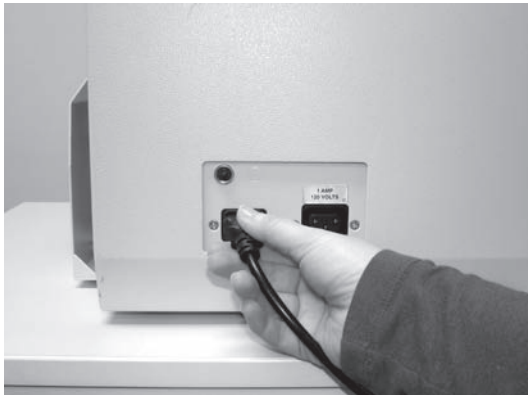

Plug power cord into the left receptacle on the back side of the machine. Plug into appropriate power supply.

## 5. Setting Catch Tray

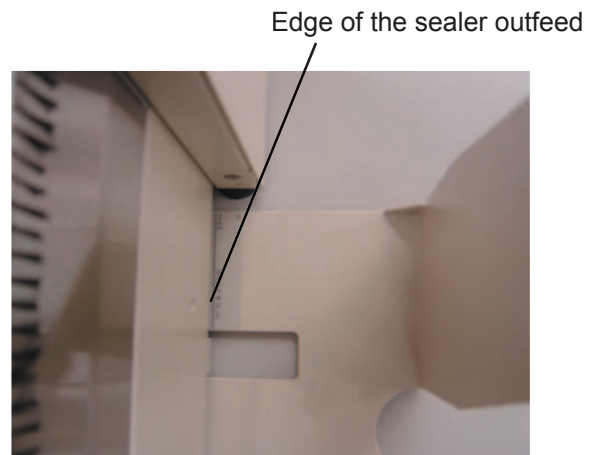
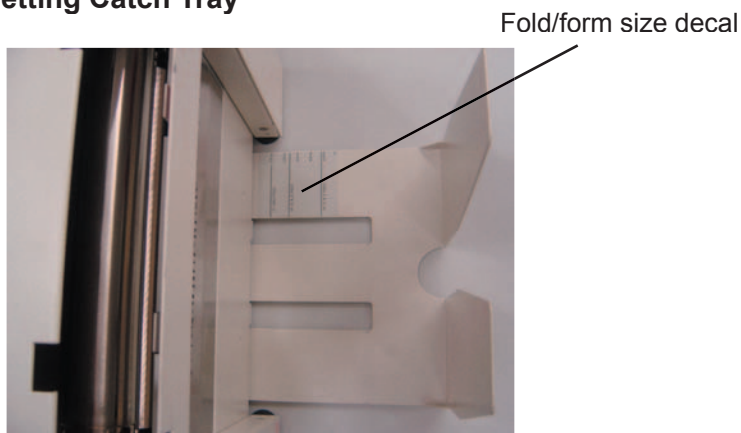

Slide the catch tray in or out to align the appropriate fold/form setting on the "Fold/form size decal" with the edge of the sealer outfeed.

## 6. Setting Infeed Side Guides

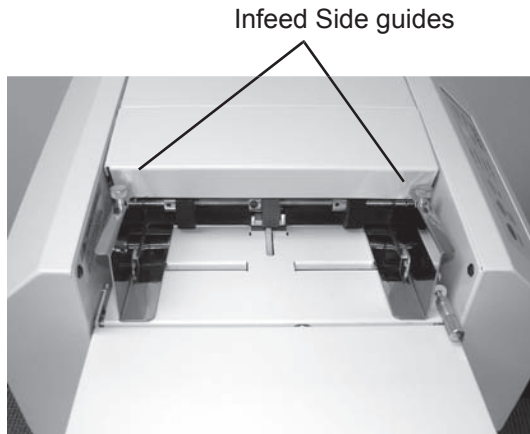

a. Place a form between the side guides. Adjust the side guides by loosening knobs on top, then sliding them toward or away from each other so that the form is snug but still lies flat.

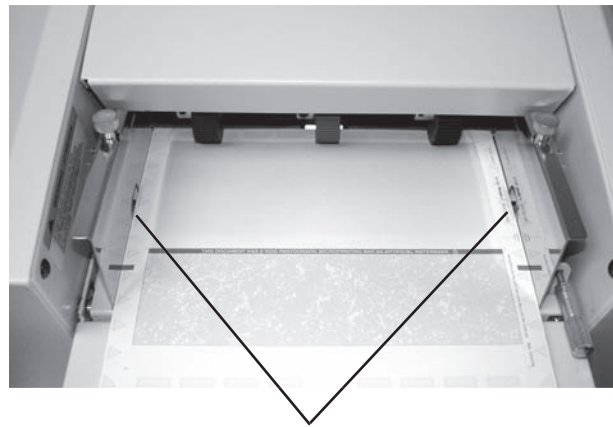

Equal spacing between side frame and guides on both sides

b. Leave equal spacing between the guides and side frame on both sides to help ensure that the forms feed squarely into the pressure sealer.

# OPERATION

## 1. Power

Power switch

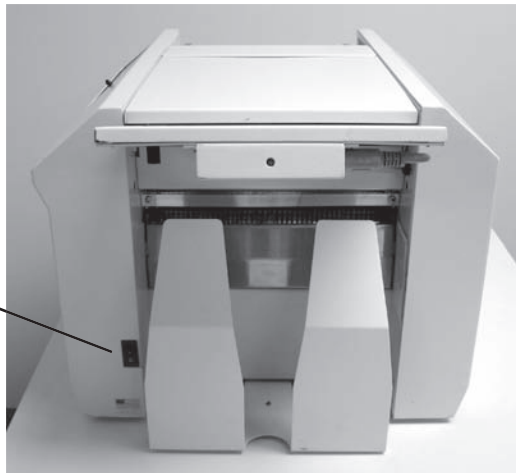

Switch the power button, located next to the catch tray, to the on position.

## 2. Loading Forms



Feed table lever

- Remove printed forms from the printer and square them so they are in a neat stack.
- Pull up the feed table lever.
- Place the neatly stacked forms onto the feed table with the glue edge leading (refer to "Determining Fold Type" on Pg. 6).
- Release feed table lever.

## Control Panel

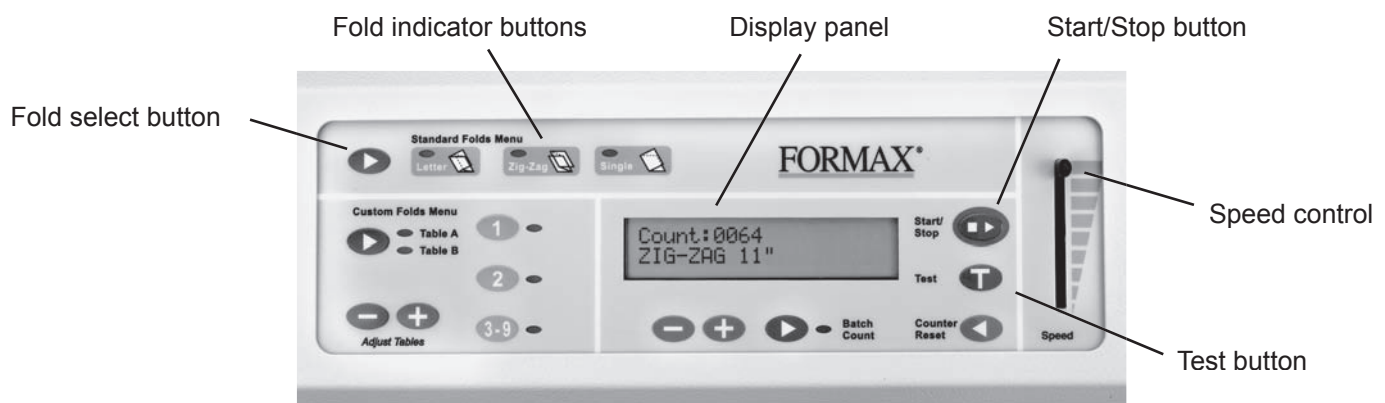

## Selecting Fold Type and Speed



1. Press the fold selection button to choose the desired fold type. (Paper size will be automatically detected.) Refer to “Determining Fold Type” on page 7.



2. After the fold plates are adjusted, press the test button. One form will be folded and sealed for inspection.



3. Press the start/stop button to begin processing. Press the same button to stop.



4. To adjust processing speed, move the speed control slider up or down.

# DETERMINING FOLD TYPE

Two Standard Folds 11" "Z" & 11" "C"  
Refer to Operator Manual for custom fold setup.

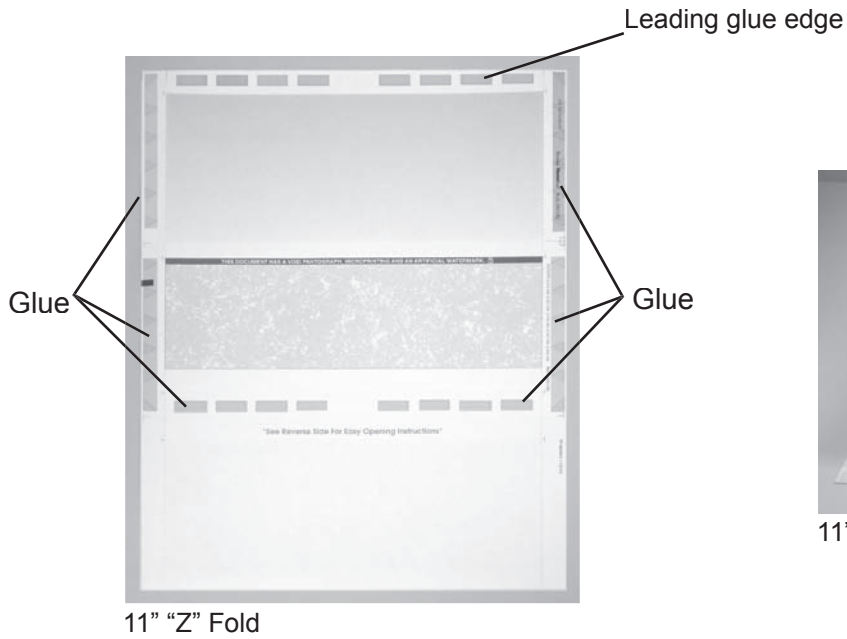

11" "Z" Fold

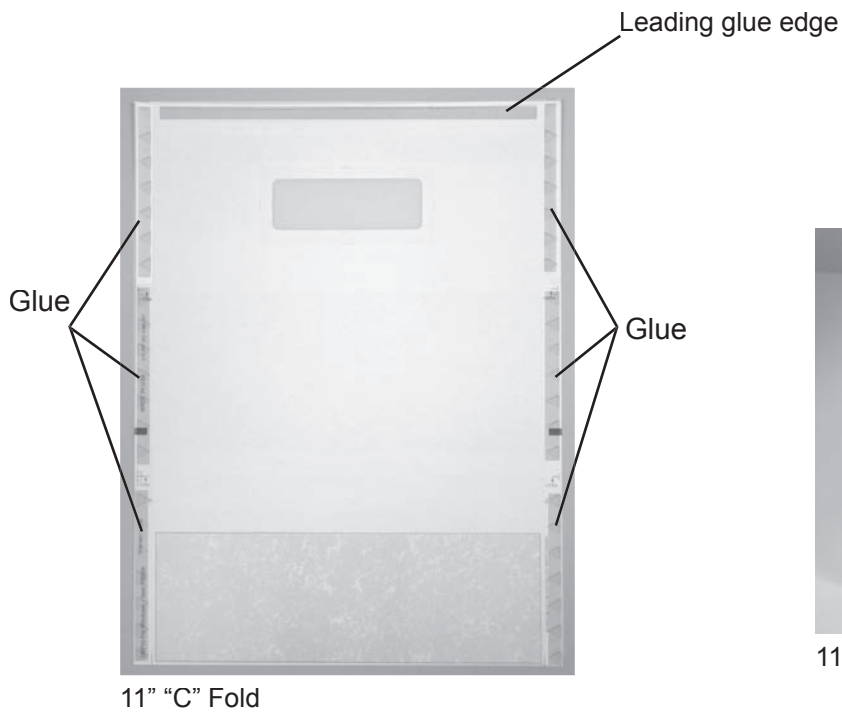

11" "C" Fold

# Leading Edge



Make copies of this page on copy paper for fine tuning folds

## Instruction For Lining Up Folds

1. Place a stack of these sheets into the feeder and fold one (1) or two (2) sheets.

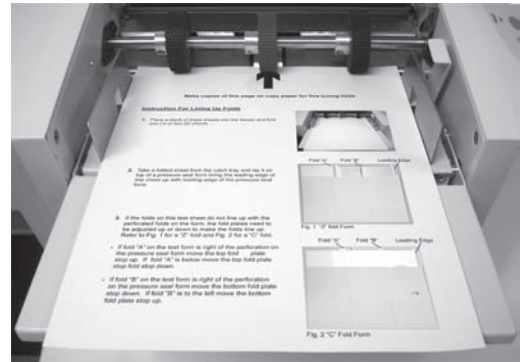

2. Take a folded sheet from the catch tray and lay it on top of a pressure seal form lining the leading edge of this sheet up with leading edge of the pressure seal form.

3. If the folds on this test sheet do not line up with the perforated folds on the form, the fold plates need to be adjusted up or down to make the folds line up. Refer to Fig. 1 for a "Z" fold and Fig. 2 for a "C" fold.

- If fold "A" on the test form is to the right of the perforation on the pressure seal form move the top fold plate stop position up. If fold "A" is to the left move the top fold plate stop position down.
- If fold "B" on the test form is to the right of the perforation on the pressure seal form move the bottom fold plate stop position down. If fold "B" is to the left move the bottom fold plate stop position up.

Fold "A" Fold "B" Leading Edge

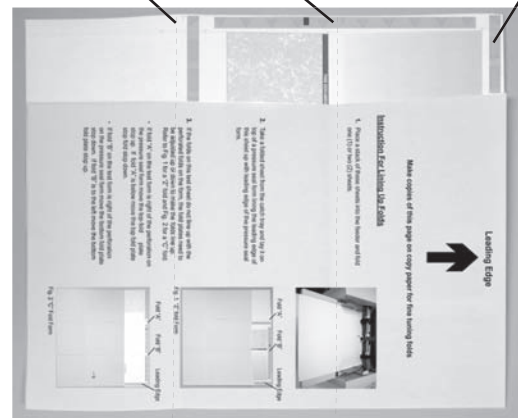

Fig. 1 "Z" fold Form

Fold "A" Fold "B" Leading Edge

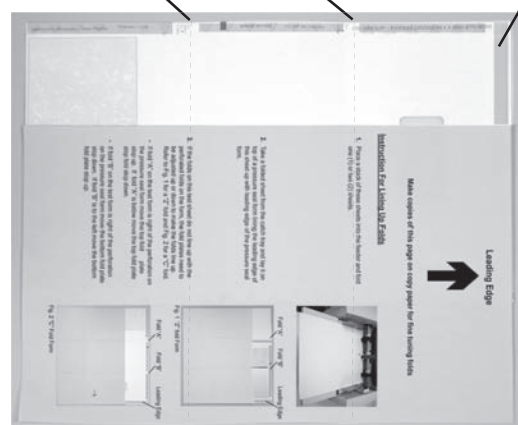

Fig. 2 "C" Fold Form