

FORMAX[®]

CT-20

Conveyor Stacker

Assembly, Operation & Parts Manual
First Edition

TABLE OF CONTENTS

SPECIFICATIONS	1
UNPACKING	1
CONTENTS	2
ASSEMBLY	3
SETUP AND OPERATION	4
PARTS	6

SPECIFICATIONS

POWER	110 VAC 60 HZ
FUSE	1 AMP / 110V
BELT SPEED	VARIABLE, 0 TO 100 FT PER MINUTE
DIMENSIONS WITH TRAY	45.5" L x 12.5" W x 25" - 34" H (from top of deck to the floor)
Capacity	Up to 450 #10 Envelopes*
WEIGHT	94 LBS

*Capacity will vary based on thickness

UNPACKING

INSPECT FOR SHIPPING DAMAGE, MISSING PARTS AND PROPER OPERATION. REPORT SHIPPING DAMAGE TO THE CARRIER IMMEDIATELY. SAVE THE SHIPPING CARTONS AND MATERIALS IN CASE THEY ARE NEEDED TO FILE A SHIPPING CLAIM OR FOR FUTURE SHIPPING USE.

1. Check the outside of the carton for visible damage. Make note of any damage on the carrier's receiving report.
2. Open the carton.
3. Carefully remove the contents and inspect the unit for paint and structural damage.
4. Carefully check for missing parts. If damage or missing parts are noted, contact your Sales Representative immediately. Save cartons and packing materials. They may be required to substantiate a damage claim or to return a damaged unit.

COMPONENTS

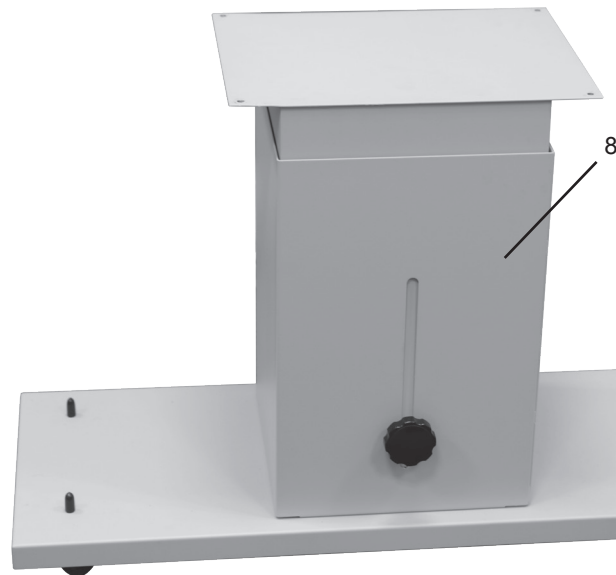
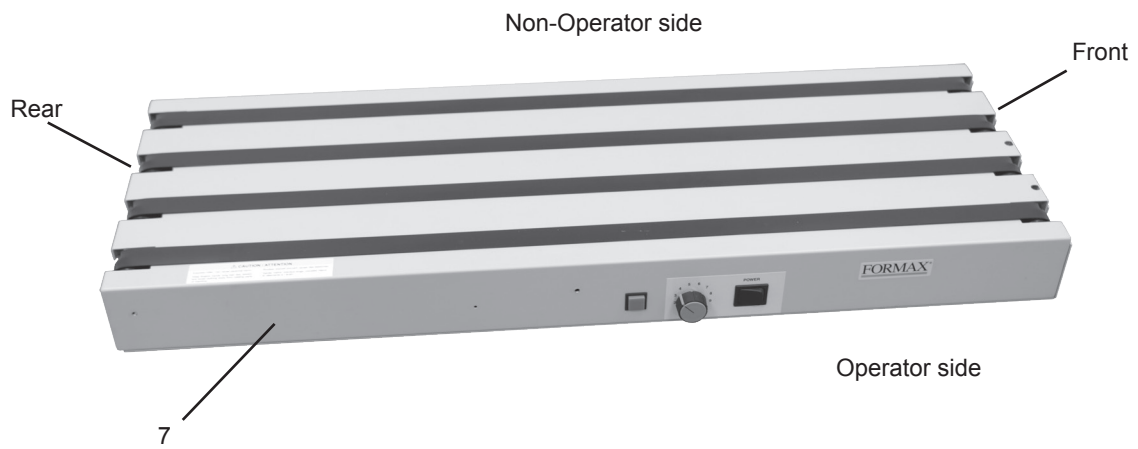
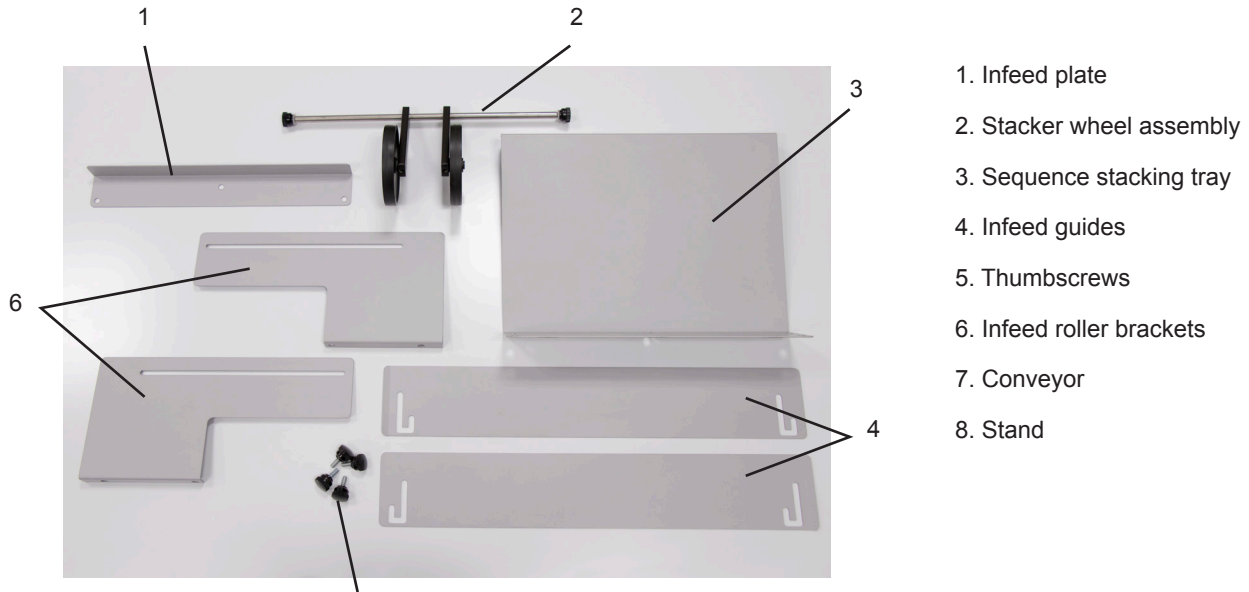

ASSEMBLY

1. Mount the conveyor to the stand. Turn the conveyor up on the non-operator side and remove the four center screws from the bottom plate of the conveyor. Place the conveyor on top of the stand and align the holes. Use the removed button head screws to mount the conveyor to the stand.



2. Mount the Infeed Plate. Remove the three button head screws from the front of the conveyor and use them to mount the infeed plate to the front of the conveyor.

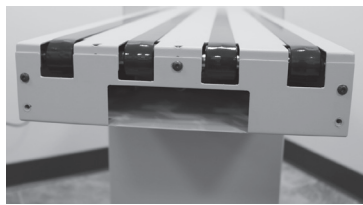

3. Mount the Infeed stacker wheel brackets. Remove the four button head screws located on the bottom side of the conveyor closest to the front. Use the removed screws to mount the brackets.



3. With the brackets in position mount the infeed stacker wheels to the bracket with the provided thumbscrews.



4. Mount the infeed guides to the operator and non-operator side of the conveyor with the thumbscrews provided. The guides should be mounted so that the flared edge is facing out and toward the front of the conveyor.



5. Mount the Sequence Stacking Tray. Remove the five button head screws from the rear of the conveyor and use them to mount the tray to the rear of the conveyor. The top of the tray should be flush with the top of the conveyor.

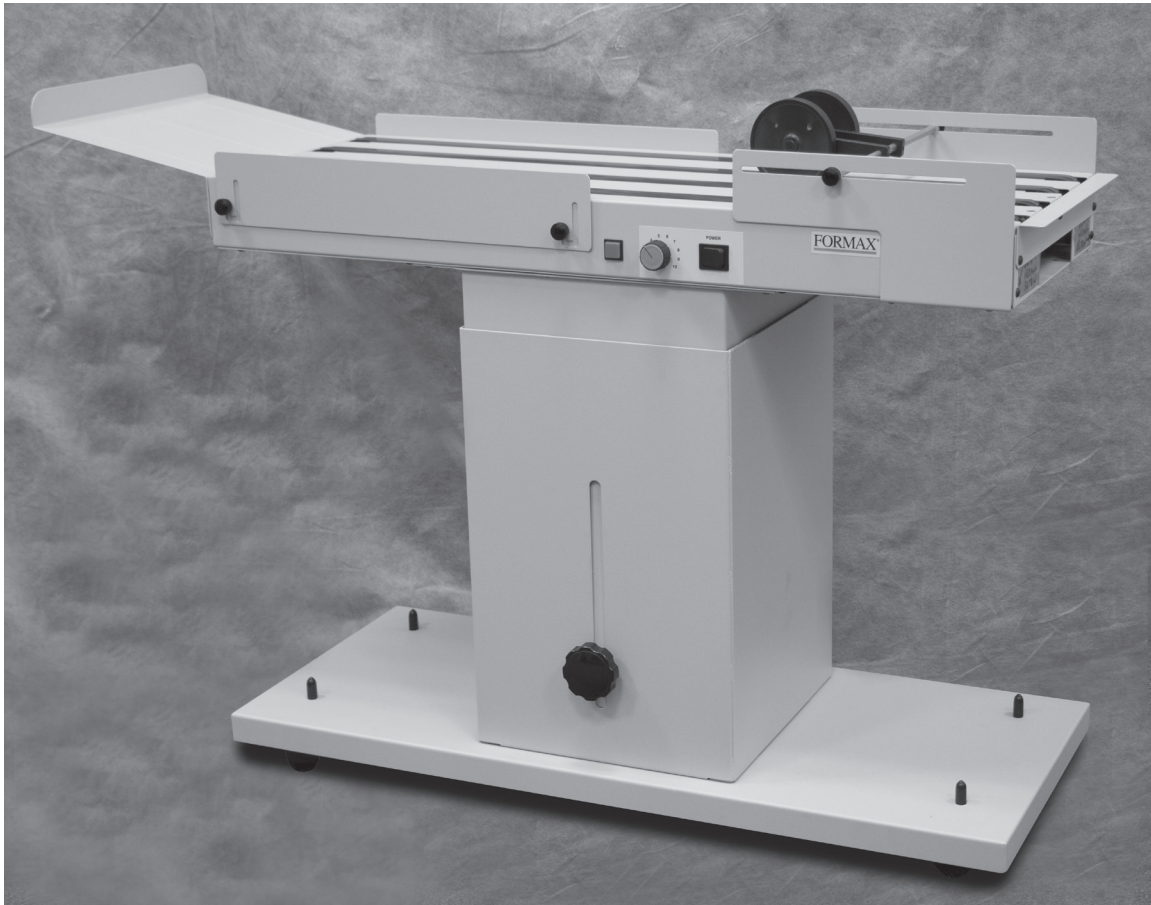
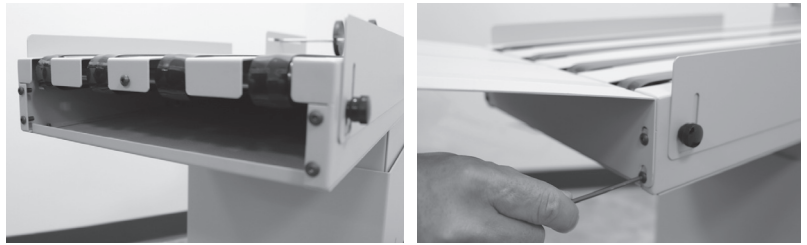

SETUP AND OPERATION

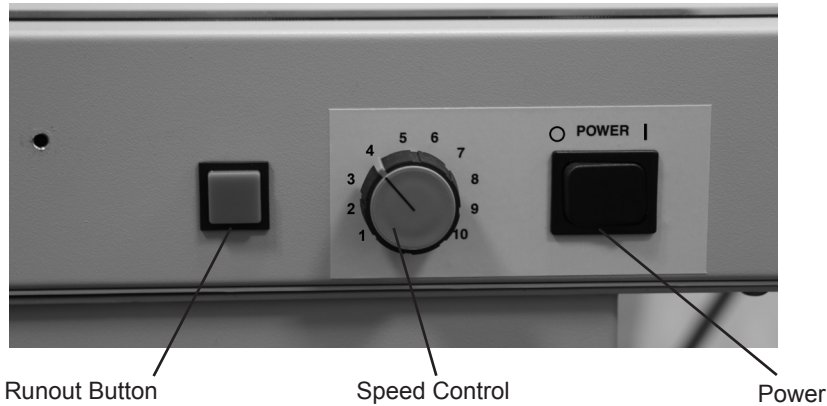

1. Connect the cord to the conveyor and plug it into the wall outlet.



2. Set the height of the conveyor to match the outfeed of the printer/feeder. Carefully loosen the two knobs on either side of the conveyor stand to raise or lower the stand height, a second person may be required. The top of the conveyor should sit below the exit of the printer when rolled into position.



3. Turn the black power switch to the on position. The blue runout button will light up when the power is in the on position.

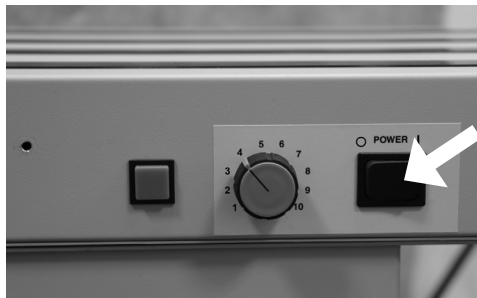

4. Setting the stacking shingle. Use the speed control knob to adjust the tightness of the shingle stack. Slower speeds will create a tighter shingle, faster speeds will increase the shingle spacing. Adjust the stacker wheels in or out to accommodate the envelope coming out of the printer. Closer for smaller media and further out for larger media. Press and hold the blue runout button to neatly gather media off the conveyor.

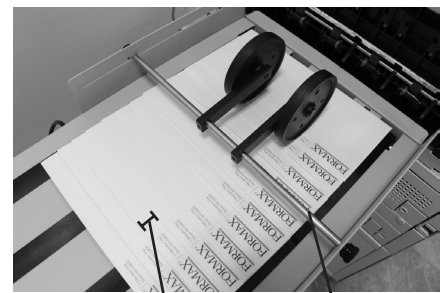
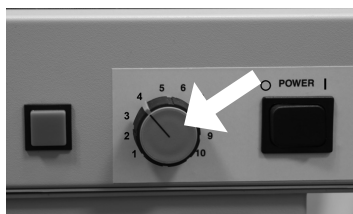

Shingle Distance Stacker Wheels

PARTS

CONVEYOR PARTS

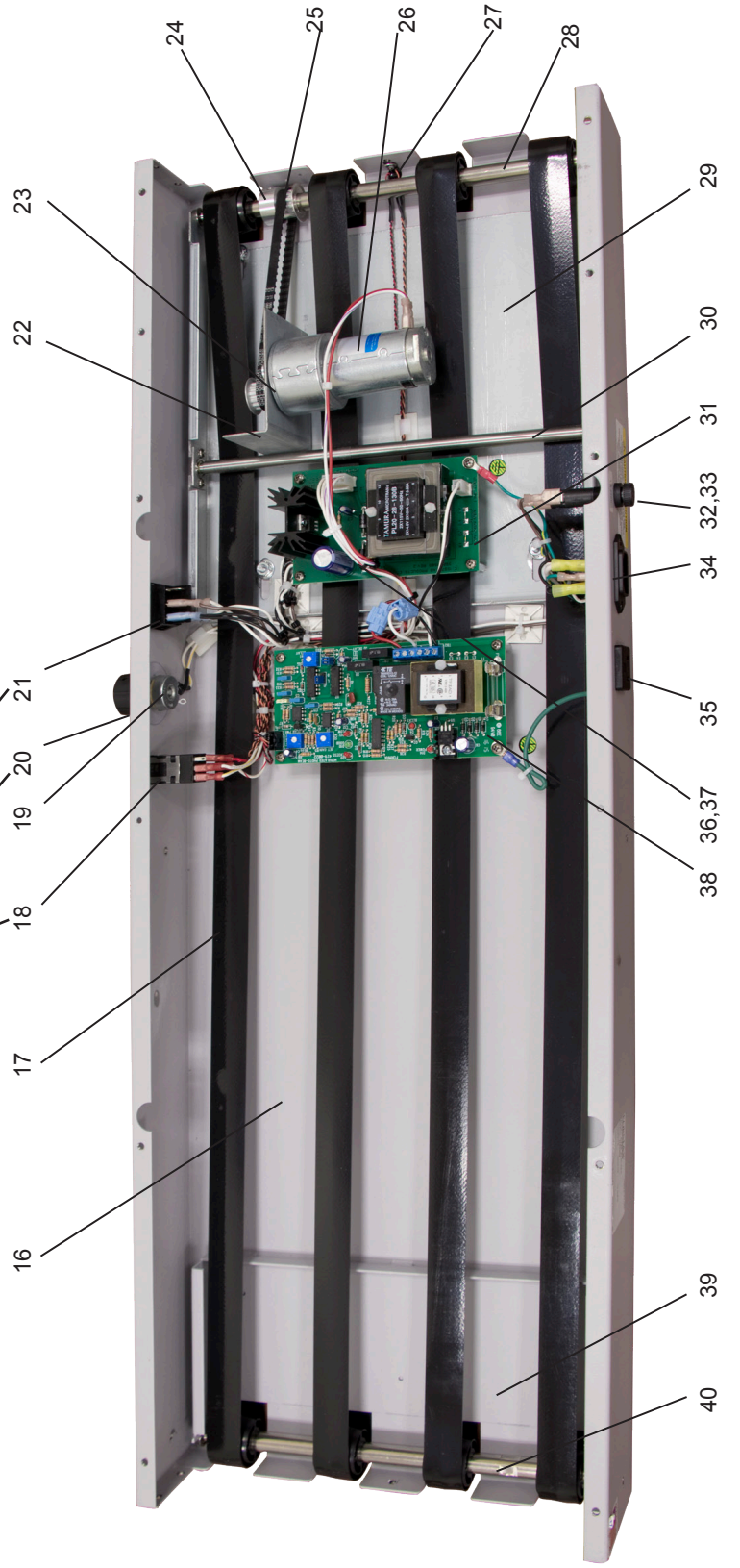
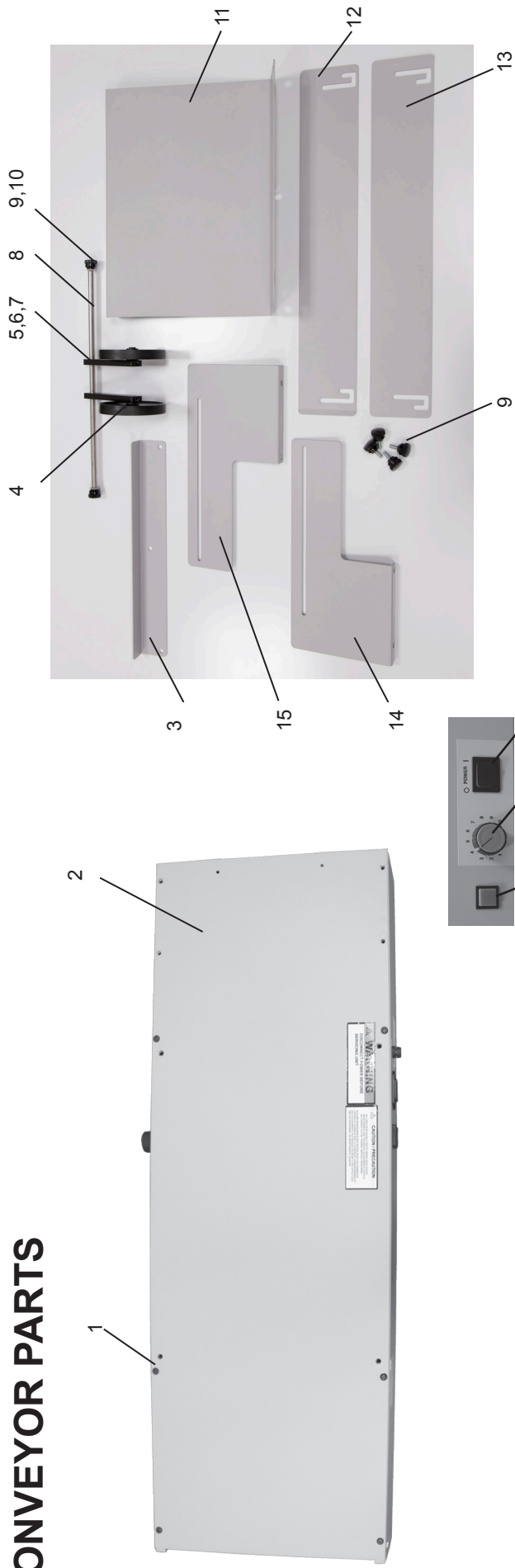

CONVEYOR PARTS

ITEM	PART #	DESCRIPTION	QTY
1	375-5699	SCREW 10-32 X 1/4 BUTTON HD CA	19
2	360-2316	BOTTOM PAN, 36" N/P	1
3	360-3079	INFEED PLATE, CT20	1
4	320-0011	WEIGHTED STACKER WHEEL, OFP	2
5	361-8136	STACKER WHEEL ARM	2
6	380-5538	** OPX ** NYLON PELLET	2
7	376-0077	10-32 Set Screw	4
8	332-0187	ROD, INFEED-OUTFEED WHEELS	1
9	372-0124	HAND KNOB 10-32	6
10	377-0078	NYLON WASHER .385x.75x.031 >	4
11	360-3062	SEQ TRAY CT20 STACKER	1
12	360-3081	REAR SIDE GUIDE, CT20	1
13	360-3080	FRONT SIDE GUIDE, CT20	1
14	360-3083	REAR INFEED BRACKET, CT20	1
15	360-3082	FRONT INFEED BRACKET, CT20	1
16	360-2404	DECK LF/RT 36" N/P	1
17	369-0050	TRANSPORT BELT 35" CONVEYOR	1
18	311-0023	PUSH BUTTON SWITCH	1
19	372-0061	CONTROL KNOB	1
20	319-0031	REMOTE POT	1
21	311-0051	TRAVEL/PHOTO-EYE SWITCH	1
22	360-1575	BRACKET, MOTOR 36"	1
23	365-0181	MOTOR PULLEY 22 X L037 .250 BORE	1
24	365-0167	PULLEY DRIVEN	1
25	365-0173	TIMING BELT,70 GRV,X.375 W,1/5 PT	1
26	313-0043	MOTOR 12 VDC	1
27	310-0134	PHOTO EYE W/ HARNESS	1
28	395-0751	STACKER SPOOL ASSY. WITH TIMING PULLEY	1
29	360-1586	BRACKET, SHAFT	1
30	395-0829	IDLER SHAFT ASSY	1
31	390-1424	P.C.B. 12 VDC MOTOR CONTROL 120 Volt	1
32	317-0006	FUSE HOLDER	1
33	317-5183	1 AMP FUSE 110 Volt	1
34	319-1052	AC POWER OUTLET	1
35	319-0096	IEC POWER INLET	1
36	310-0327	MOTOR HARNESS	1
37	310-0328	LINE VOLTAGE HARNESS	1
38	490-0022	MODULATED BEAM PCB	1
39	360-1580	BRACKET,RLR ADJUST 36'	1
40	395-0750	STACKER SPOOL ASSY. WITH OUT TIMING PULLEY	1

STAND PARTS

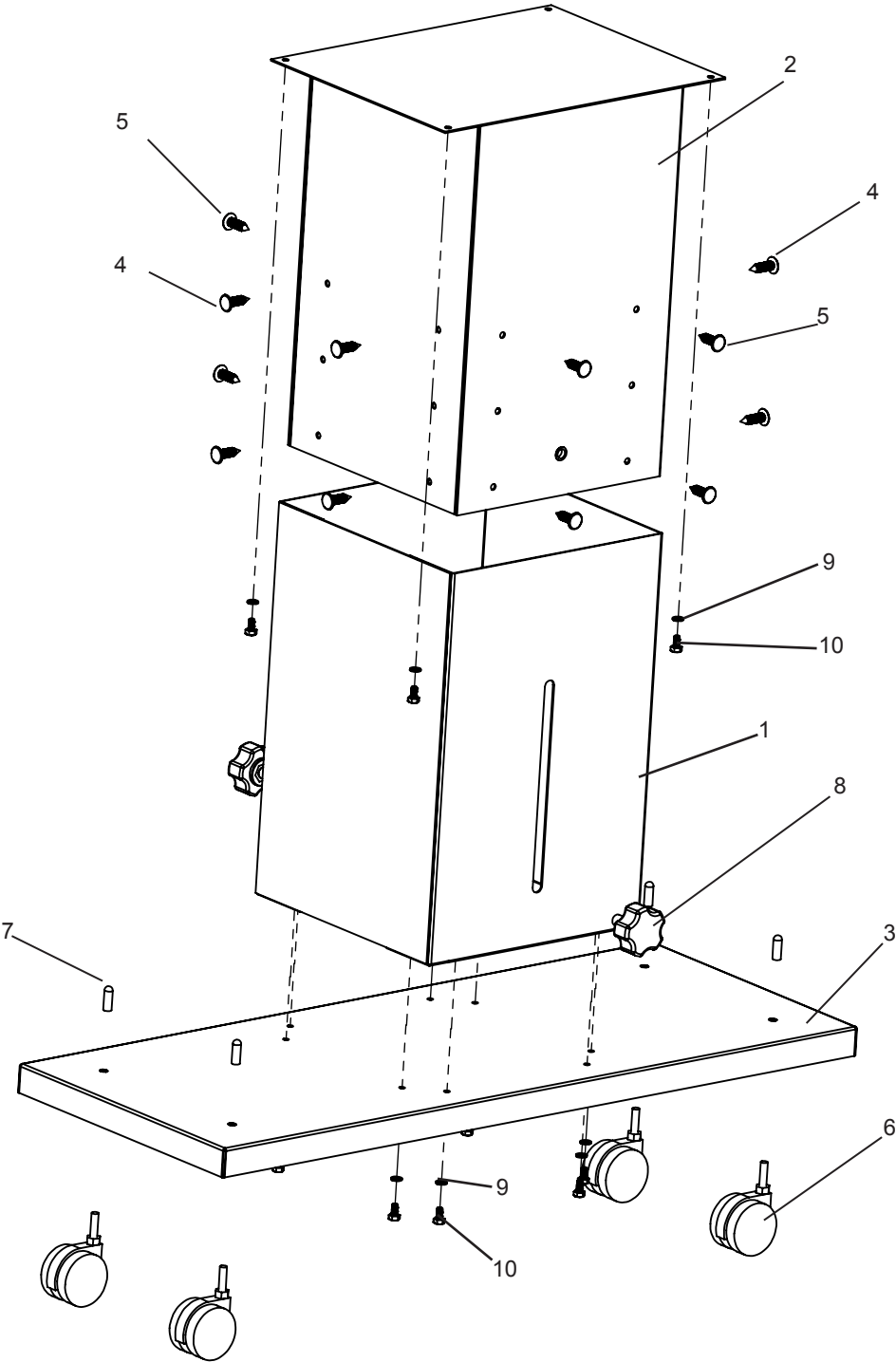

STAND PARTS

ITEM	PART #	DESCRIPTION	QTY
1	360-3053	STAND, OUTER SLEEVE	1
2	360-3054	STAND, INNER PANEL	1
3	360-3055	STAND, BOTTOM	1
4	381-0175	PUSH IN RETAINER, TEXTURED	8
5	381-0174	PUSH IN RETAINER	8
6	372-0059	CASTOR	4
7	323-0041	END CAP 1 in x 1/4 DIA.	4
8	372-0127	HAND KNOB, 1/2 - 13 STUD	2
9	377-2611	WASHER 1/4 SPLIT	12
10	375-2802	1/4-20 X 1 HALF SCREW	12

DATE	SYM	REVISION	RECORD	AUTH.	DR.	CK.
3/8/17	-	ERN-5255			TY	

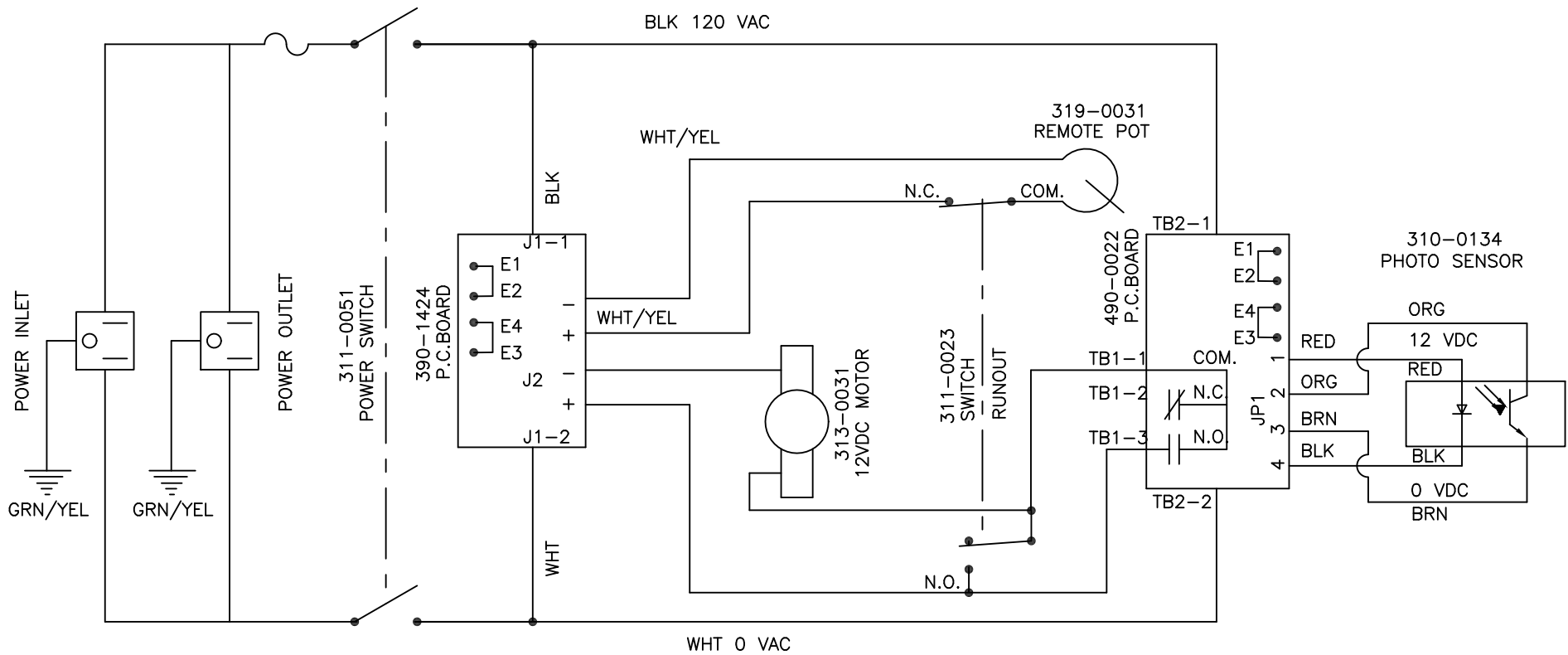

UNLESS OTHERWISE NOTED:
 -DEBURR ALL SHARP CORNERS & EDGES
 -DIMENSIONS TO BE MAINTAINED AFTER PLATING APPLICATION
 -DIMENSIONS ARE IN INCHES
 -MINIMUM BEND RADI

TOLERANCES:

SURFACE	✓
.XX	± .015
.XXX	± .005
ANGLES	± 1°

MATERIAL

FINISH

		DRAWN T. YORK	DATE 3/8/17
		CHK	
	CT20	ENGR	
NEXT ASSY	MODEL		

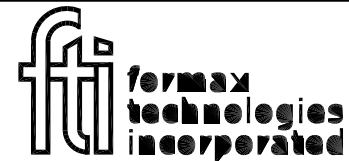

TITLE
 SCHEMATIC CT20
 STACKER

SCALE N/A	SIZE A	DRAWING NO.	SHEET 1 of 1	REV. -
--------------	-----------	-------------	-----------------	-----------

THIS DOCUMENT AND SUBJECT MATTER ARE CONFIDENTIAL AND MAY NOT BE USED, EITHER DIRECTLY OR INDIRECTLY WITHOUT THE EXPRESS CONSENT OF FORMAX TECHNOLOGIES INC., TURLOCK, CA.